

PUNTE TIPO KOMATSU

KOMATSU TYPE TIPS

ZAHNSPITZEN TYP KOMATSU

POINTES TYPE KOMATSU

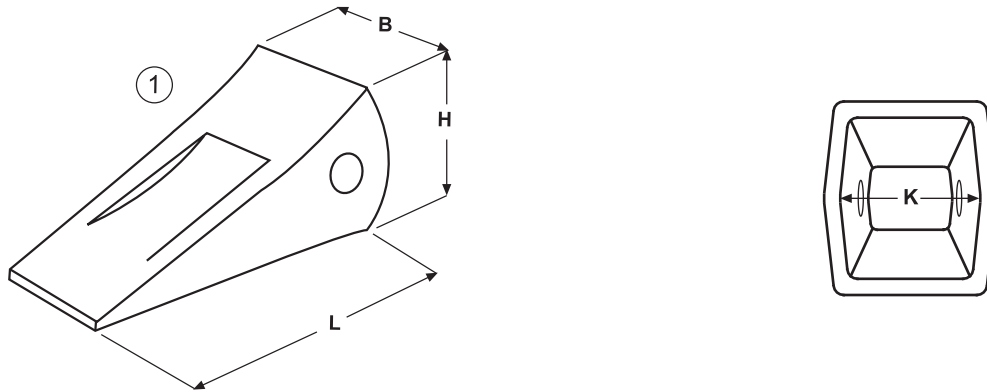

NS. RIF. OUR REF. UNS. REF. NOTRE REF.	N. ORIGINALE ORIGINAL NO. ORIGINAL NR. N. D'ORIGINE	FIGURA FIGURE FIGUR FIGURE	DIMENSIONI - DIMENSIONS - ABMESSUNGEN - DIMENSIONS				PESO WEIGHT GEWICHT POIDS (KG)	PORTAPUNTA ADAPTER HALTER PORTE-POINTE	PERNO PIN BOLZEN AXE
			L	B	H	K			
E 494	205-70-19570	1	220	85	100	76	4.0	E 484 - E 484.1	E 490
E 495	207-70-14151	1	238	107	113	93	5.7	E 485 - E 485.1	E 491
E 496	208-70-14152	1	280	140	121	110	9.7	E 486.1	E 492

PERNI PER PUNTE TIPO KOMATSU

PINS FOR TIPS TYPE KOMATSU

BOLZEN FÜR ZAHNSPITZEN TYP KOMATSU

AXES POUR POINTES TYPE KOMATSU

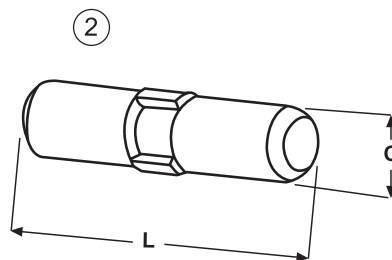

NS. RIF. OUR REF. UNS. REF. NOTRE REF.	N. ORIGINALE ORIGINAL NO. ORIGINAL NR. N. D'ORIGINE	FIGURA FIGURE FIGUR FIGURE	DIMENSIONI - DIMENSIONS - ABMESSUNGEN - DIMENSIONS		PORTAPUNTA ADAPTER HALTER PORTE-POINTE	PUNTA TIP SPITZE POINTE
			L	C		
E 490	09244-02496	2	96	25	E 484 - E 484.1	E 494
E 491	09244-02516	2	117	25	E 485 - E 485.1	E 495
E 492	09244-03036	2	136	30	E 486.1	E 496



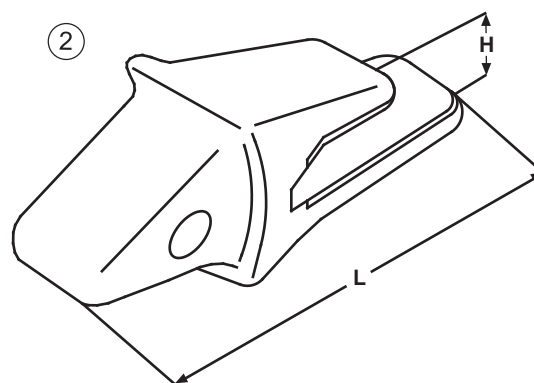
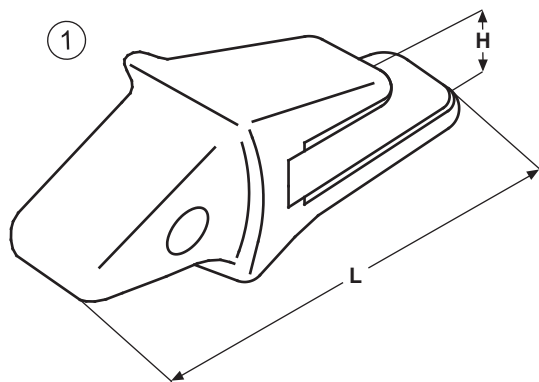

PORTAPUNTA A SALDARE TIPO **KOMATSU** PER ESCAVATORI
 KOMATSU TYPE WELD-ON ADAPTERS FOR EXCAVATORS
 ZAHNHALTER ZUM ANSCHWEIßEN TYP KOMATSU FÜR BAGGER
 PORTE-POINTES À SOUDER TYPE KOMATSU POUR EXCAVATEURS

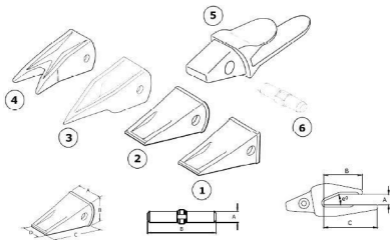

MODELLO MODEL MODELL MODÈLE	NS. RIF. OUR REF. UNS. REF. NOTRE REF.	N. ORIGINALE ORIGINAL NO. ORIGINAL NR. N. D'ORIGINE	FIGURA FIGURE FIGUR FIGURE	DIMENSIONI - DIMENSIONS ABMESSUNGEN - DIMENSIONS		PESO WEIGHT GEWICHT POIDS (KG)	PUNTA TIP SPITZE POINTE	FORZA DI STRAPPO BREAK-OUT FORCE ZUGFESTIGKEIT FORCE D'ARRACHEMENT (KG)
				L	H			
PC200 - PC220 PW 210	E 484	205-939-7120	1	290	33.5	7.0	E 494	15500
	E 484.1	205-70-68141	2	290	33.5	7.0		
PC300 - PC360	E 485	207-939-3120	1	367	42	13.5	E 495	22500
	E 485.1	207-70-14142	2	367	42	14.0		
PC 400	E 486.1	208-70-14143	2	411	47	21.5	E 496	29500



	FIG.	ETE	O.E.M.	A	B	C	D	KG	
PC100, PC-120	1	1204	202.70.12130	92	85	202	67	3,6	
	5	5204	202.70.12140	30	82	185		6,6	
	6	2921	092.44.02496	25	96			-	
PC-150, PC-180, PC-200	2	1947	205.70.19570	72	95	220	77	4,7	35
	5	5207	205.70.68141	38	120	182		6,8	
	5	5207-S	205.93.97120	38	120	182		6,7	
	6	2921	092.44.02496	25	96			-	
PC-300, PC-360	2	1948	207.70.14151	108	114	250	98	6,8	45
	3	1665	207.70.14151-T	123	113	281	R5	7,6	
	4	1660	207.70.14151-WT	123	113	281	145	8,4	
	5	5208	207.70.14142	46	157	238		13,5	
	5	5208-S	207.93.93120	46	157	238		12,9	
	6	2920	207.93.93120	25	118			-	
PC-400, PC-500	2	1209	208.70.14152	153	126	271	111	9,5	50
	3	1211	208.70.14152-T	150	124	343	R6	13,0	
	4	1212	208.70.14152-WT	144	122	346	167	13,9	
	5	5209	208.70.14143	51	155	310			
	5	5209	208.70.14143	51	155	310			
	6	2924	092.44.03036	30	146				

* ETE-5207-S & ETE-5208-S: SIN BISEL / WITHOUT BEVEL

